

Tous droits strictement réservés. Reproduction ou communication a des tiers int sous quelque forme que ce soit sans autorisation écrite du propriétaire. propriété de c BERG ELECTRONICS. Droits de reproduction BERG ELECTRONICS by

All rights strictly reserved. Reproduction or issue to third parties in any for whatever is not permitted without written authority from the proprietor. Property of c BERG ELECTRONICS. Copyright BERG ELECTRONICS by

| PRODUCT NUMBER | COLOR | PACKING METHOD |
|----------------|------------------|-------------------------|
| 56405-001 | OPAQUE BLACK | PACKING WITH BUBBLE BAG |
| 56405-002 | TRANSLUCENT GRAY | PACKING WITH BUBBLE BAG |
| 56405-001T | OPAQUE BLACK | PACKING WITH TRAY |
| 56405-002T | TRANSLUCENT GRAY | PACKING WITH TRAY |

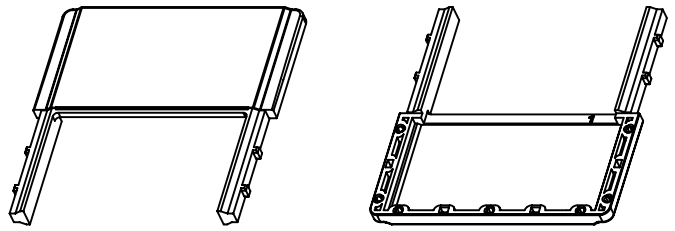
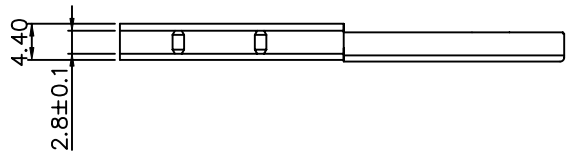
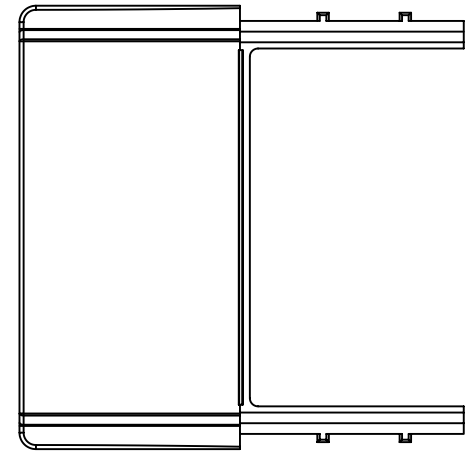
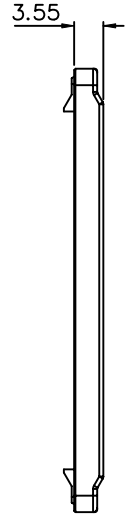
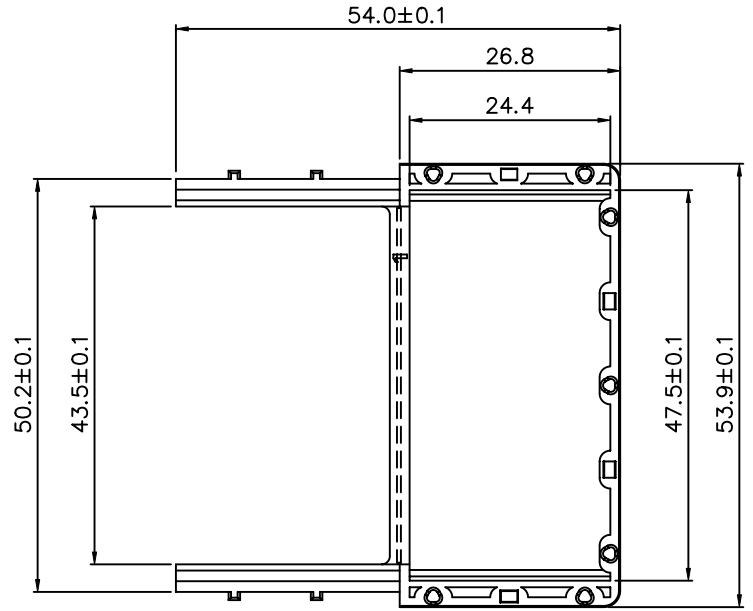

NOTES:
 1.MATERIAL: POLYCARBONATE G.E. LEXAN 940.
 2.REFER TO TA-667 FOR OVERALL ASSEMBLY VIEWS

| | | | | | | | | | | |
|------------|----------|----|----------|--------------------------------------|------------|----------|---------------|-----------------------|------------------------|---------|
| mat'l code | | | | tolerance unless otherwise specified | | | CUSTOMER COPY | | www.fciconnect.com | |
| rev. | ecn no. | dr | date | linear | ±0.3 | | projection | title | | |
| A | T10334 | WL | 11/23/01 | | ±2° | | | LOWER COVER | | |
| B | T20299 | WL | 10/07/02 | angles | ±2° | | | product family PCMCIA | | code |
| C | T03-0245 | WL | 06/23/03 | | ±2° | | | size | | dwg no. |
| D | T04-0045 | WL | 02/02/04 | dr | WENDY CHEN | 06/09/01 | unit | product family PCMCIA | | code |
| | | | | enr | YUWEN CHU | 06/09/01 | mm/inch | size | | dwg no. |
| | | | | chr | YUWEN CHU | 06/09/01 | scale | A3 | | 56405 |
| | | | | appd | JENN TSAO | 06/09/01 | | | | 1 OF 1 |
| sheet | revision | D | | | | | | | | |
| index | sheet | 1 | | | | | | | | |